

LINUS T-RACK Data Sheet

LINUS T-RACK

12-Channel Touring Rack



Enjoy rugged and reliable amplification with the T-RACK, a 12-channel system rack that is both heavy-duty enough to be used in all scenarios and flexible enough to be flown or ground stacked. Deploy the system exactly how you want.

Our racks are also totally expandable, rack-to-rack cabling means you can chain them for more power, and they are even compatible with the M-RACK system for even more compatibility.

Whether you need power for FOH system control, monitor systems, delay systems, zoned systems, or any other application, the T-RACK is always dependable.

With three inbuilt LINUS14/D amplifiers, you can bring spectacular power to any live show. A total of 42,000W RMS (12x3500W amplifiers @ 4 Ohm) means this is perfect for a huge number of live applications, and with the option to chain and 2U of free rack space, the T-RACK's power means no limitations to the show you want to create.

You even have the option to create a simple and convenient touring rack by hooking two T-RACKs together. Extend and grow your system to perfectly tailor to the needs of your show. Simply connect your T-RACK systems using the multi-pin cable extension via the optional PAN-MP connecting panel, if required.

The systems come with shock-mount suspensions for added protection as well as all of the rigging hardware and optional accessories, dollies, and transport you need, whether your system is flown or ground stacked.

T-RACK is a protective grille on the rear of the unit and a rugged design, meaning a reliable amplification companion is yours for years to come. You can always rely on the quality of these products, which are made in Europe and include a 5-year manufacturer's warranty.

The flexibility and reliability to drive your CODA Audio system, all in one convenient rack.

LINUS T-RACK Features

- ⊕ 3x LINUS14/D amplifiers in a 10U heavy-duty rack
- ⊕ Delivers 12x 3500 W @ 4 Ohm
- ⊕ Integrated shock-mount suspension system for maximum protection
- ⊕ Integrated rigging hardware for flown or ground stacked deployment
- ⊕ Rear mounted power distribution (optional switchable: US / EU)
- ⊕ Selectable inputs: Analog, AES over Ethernet, LiNET
- ⊕ Outputs on NL4, NL8 (Socapex optional available)
- ⊕ 5-pin XLR comparator inputs for use with CODA Audio sensor controlled subwoofers
- ⊕ All inputs and outputs are at the front for easy workflow
- ⊕ Expandable – rack to rack internal cabling allows to join two or more racks together
- ⊕ Sliding doors for quick access
- ⊕ Protection grille on the rear
- ⊕ Can drive all CODA loudspeaker systems
- ⊕ Compatible to M-RACK



LINUS T-RACK Data Sheet



GENERAL	
Components	3x LINUS14/D 1x PAN-T Connecting Panel 1x PDU-T Power Distribution Unit 1x enclosure with integrated rigging hardware (2-point), shock mount suspension system, sliding doors on front and rear side, protection grille on the rear side
Connecting panel front side	PAN-T Powered connecting panel including two ethernet switches (one for Ethernet and one for Dante) and integrated cabling system
Analog	4x XLR Input 1x etherCON® analog Input/ Link
LINET (AES/EBU)	1x etherCON® Input (8x signal channels) 1x etherCON® Output (8x signal channels)
Dante	1x etherCON®
Remote Control	1x etherCON® Input 1x etherCON® Output Recessed push button to select AES over Ethernet signal input AES over Ethernet activated (Blue LED): Transport of remote control incl. 4x LINET (AES/EBU) signal channels on ETHERNET marked etherCON® connectors enabled. PRIM = Input / SEC = Link LINET activated (Orange LED): LINET signal and remote control sockets separated

Outputs	6x Neutrik NL4 speakON® 3x Neutrik NL8 speakON® Output section can be extended with the PAN-MP Multipin connection panel 3x LKS 19 (8x Output channels per connector for two combined LINUS T-RACKS)
Sensor Control Connection	6x XLR5
Optional	PAN-MP Output Section can be extended with the PAN-MP Multipin connection panel 3x LKS 19 (8x Output channels per connector for two combined LINUS T-RACKS)
AC input	CEE 32A 230/400V/5P
AC link	CEE 32A /400V/5P Type F 16A Schuko female outlet protected by a C16 circuit breaker (incl. PAN-T)
Optional power distribution unit for operation in EU and US	PDU-T INT Power distribution unit with integrated cabling system for amplifiers and connecting panel operated in EU and US
AC input	EU: CEE 32A 230/400V/5P US: L21-30 120/208V Power inlet switchable on the backside of the power distribution unit
AC link	CEE 32A/400V/5P EU: Type F 16A Schuko female outlet US: 5-15 female outlet Both protected by a 10A/1P circuit breaker (incl. PAN-T)
PHYSICAL	
Enclosure material	Birch plywood
Finish	Polyurea coating
Dimensions (WxHxD)	607 x 547.4 x 650 mm / 23.9" x 21.55" x 25.59"
Shipping dim. (WxHxD)	627 x 567.4 x 670 mm (0.238 m³) / 24.69" x 22.34" x 26.38"
Net weight	93 kg / 205.03 lbs.
Shipping weight	96 kg / 211.64 lbs. Volume = 0.238 m³ / 8.405 ft³

* Typical values – some variation may exist due to component tolerances.

**Voltage range should not be exceeded. Amplifier output power performance will degrade below nominal voltage & increase above nominal voltage.

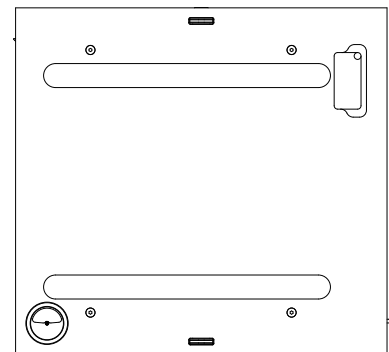
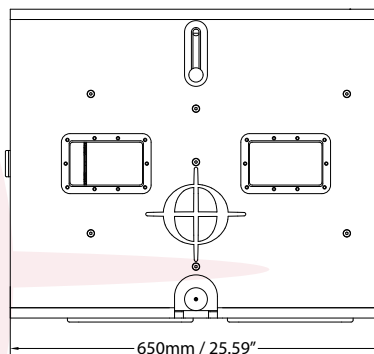
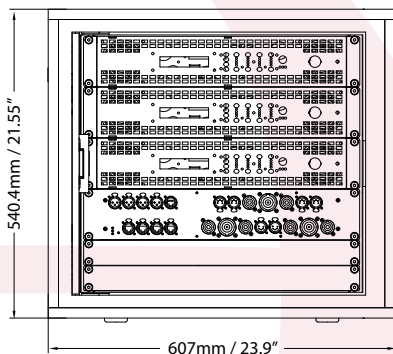

CODA AUDIO GmbH

Boulevard der EU 6, 30539 Hannover, Expo Park, Germany

E-Mail: contact@codaaudio.com Website: www.codaaudio.com

CODA
CODA AUDIO

